

STRUT CHANNEL

12 Gauge, 1⁵/₈" x 1⁵/₈" | AS-132-OS

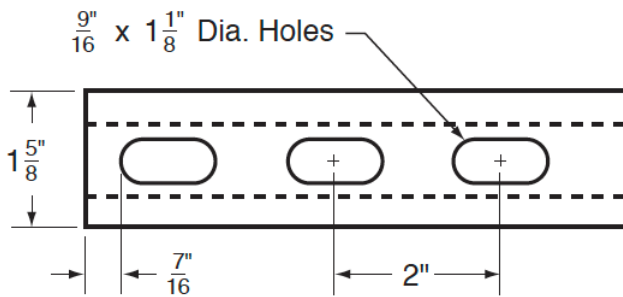
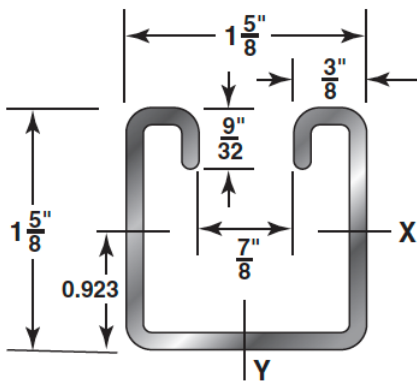
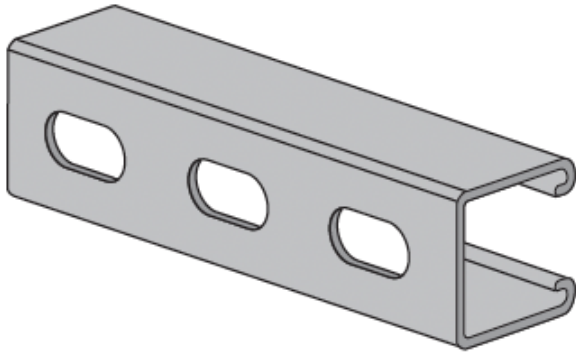

General Specification

MATERIAL	Stocked: Pre-Galvanized, Plain, Powder Coated Supr-Green, Zinc Trivalent, PVC Coated, Aluminum Upon Request: SS 304 & 316L Alloys
LENGTH	10' and 20'
QUANTITY	1 Strut Channel

Other materials, finishes and lengths are available upon request.

Compliance

PRE-GALVANIZED STEEL	ASTM A-653
PLAIN STEEL	ASTM A-1011-04-SS
ALUMINUM (TYPE 6063T6)	ASTM B-221
STAINLESS STEEL (304 & 316L)	ASTM A-240
HOT DIPPED GALVANIZED	ASTM A-123
ZINC TRIVALENT CHROMIUM	ASTM B-633-85
POWDER COATED SUPR-GREEN	ASTM B-117
PVC COATED (40ML THICKNESS)	

Design, dimensions, and materials are subject to change without notice.

Specifications

PART NUMBER	WT/FT (LBS)	AREA OF SECTION (SQ_IN)	X-X AXIS			Y-Y AXIS		
			I IN ⁴	S IN ³	r IN	I IN ⁴	S IN ³	r IN
AS-132-OS	1.89	0.552	0.188	0.208	0.584	0.236	0.290	0.654

I: Moment of Inertia S: Section Modulus r: Radius of Gyration

STRUT CHANNEL | 12 Gauge, 1⁵/₈" x 1⁵/₈"

Load Specifications

SPAN OR UNBRACED HEIGHT (IN)	STATIC BEAM LOAD (X-X AXIS)						MAX LOAD AT SLOT FACE (LBS)	COLUMN LOADING DATA (LBS)			
	MAX UNIFORM LOAD (LBS)	DEFLECTION AT UNIFORM LOAD (LBS)	UNIFORM LOAD AT DEFLECTION					MAX COLUMN LOAD (APPLIED AT C.G.)			
			SPAN/180 DEFLECTION (LBS)	SPAN/240 DEFLECTION (LBS)	SPAN/360 DEFLECTION (LBS)	WEIGHT OF CHANNEL (LBS)		k=0.65	k=0.80	k=1.00	k=1.20
12	3480	0.01	3480	3480	3480	1.9	3850	12,240	11,940	11,480	10,960
18	2320	0.03	2320	2320	2320	2.9	3710	11,540	10,960	10,130	9290
24	1740	0.06	1740	1740	1740	3.9	3530	10,690	9850	8740	7710
30	1390	0.09	1390	1390	1390	4.9	3330	9780	8740	7470	6380
36	1160	0.13	1160	1160	910	5.8	3120	8880	7710	6380	5310
42	990	0.17	990	990	670	6.8	2910	8020	6800	5470	4430
48	870	0.23	870	770	510	7.8	2710	7240	6000	4690	3810
60	700	0.35	660	490	330	9.7	2340	5910	4690	3630	2960
72	580	0.51	460	340	230	11.6	2040	4840	3810	2960	2400
84	500	0.69	340	250	170	13.6	1800	4040	3200	2480	1980
96	430	0.90	260	190	130	15.5	1600	3480	2750	2110	1670
108	390	1.14	200	150	100	17.5	1440	3050	2400	1820	NR
120	350	1.41	160	120	80	19.4	1290	2700	2110	NR	NR
144	290	2.03	110	90	60	23.3	1060	2180	1670	NR	NR
168	250	2.77	80	60	40	27.2	NR	1790	NR	NR	NR
180	230	3.18	70	50	40	29.1	NR	NR	NR	NR	NR
192	220	3.61	60	50	NR	31.0	NR	NR	NR	NR	NR
216	190	4.57	50	40	NR	34.9	NR	NR	NR	NR	NR
240	170	5.65	40	NR	NR	38.8	NR	NR	NR	NR	NR

NR: Not Recommended, KL/r may exceed 200

Notes:

1. The beam capacities shown above include the weight of the strut beam. The beam weight must be subtracted from these capacities to arrive at the net beam capacity.
2. When calculating load at center of span, multiply load from table by 0.5 and deflection by 0.8.
3. When calculating beam and column loads for aluminum, multiply by 33%.
4. Allowable beam loads are based on a uniformly loaded, simply supported beam. For capacities of a beam loaded at midspan at a single point, multiply the beam capacity by 50% and deflection by 80%.
5. The above chart shows beam capacities for strut without holes. For strut with OS holes, multiply by 88%.